

# Villa A2

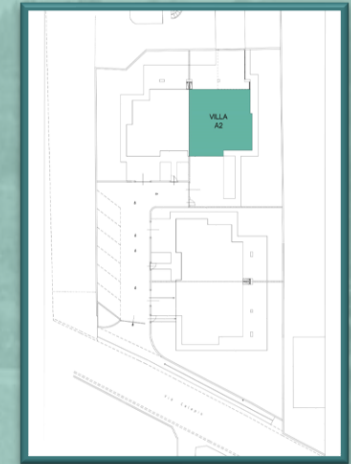

## Piano TERRA

<b>Sup. COMMERCIALE Piano TERRA</b>	<b>116,54 mq</b>
Sup. PORTICO e VERANDA	49,53 mq
Sup. GIARDINO e VIALETTI	255,33 mq



# Villa A2

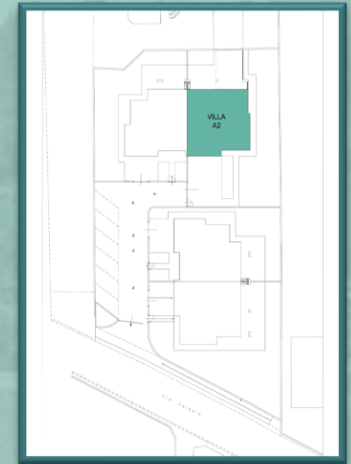

## Piano PRIMO

Sup. COMMERCIALE Piano PRIMO	108,40 mq
Sup. BALCONI e TERRAZZE	39,45 mq

